

# TEES MÉCANIQUE / Style 87G

## QUIK-T™ TEES MÉCANIQUE

Pression de service max: 20 bar.  
Contactez Modgal pour les informations sur la pression de service pour la protection incendie.

### STYLE 87G

Croix Rainuré / Kreuz Genutet / Kruis Gegroeft

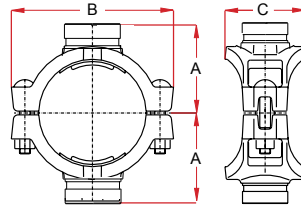

## QUIK-T™ KREUZANBOHRSCHELLEN

Maximaler Betriebsdruck: 20 bar  
Die Brandschutzzulassungen und die Zulassungs-nenn-drücke erhalten Sie bei Modgal.

## QUIK-T™ MECHANICAL TEES

Maximale werkdruk: 20 bar  
Contacteer Modgal voor toegelaten druk-  
klassen voor brandbeveiligingstoepassingen.

Diamètre nominal (Pouce / DN)		Diamètre extérieur du tuyau	Sortie	Quik-T™ Dimensions			Diam. du trou Tolerance +2.0mm	Boulons			Poids Kg.	Certifications
Principal	Sortie			Taille	A	B		C	No.	Dimension		
2" / 50	1¼" / 32	60.3	42.4	76.5	135.0	82.0	44.5	2	M10	57.0	1.96	FM / UL / LPCB / VDS
	1½" / 40	60.3	48.3	76.5	135.0	82.0	44.5	2	M10	57.0	1.97	FM / UL / LPCB / VDS
2½" / 65	1¼" / 32	76.1	42.4	82.0	150.0	92.0	50.8	2	M12	76.0	2.15	FM / UL / LPCB / VDS
	1½" / 40	76.1	48.3	82.0	150.0	92.0	50.8	2	M12	76.0	2.32	FM / UL / LPCB / VDS
3" / 80	1¼" / 32	88.9	42.4	95.0	160.0	95.0	50.8	2	M12	76.0	2.55	FM / UL / LPCB / VDS
	1½" / 40	88.9	48.3	95.0	160.0	94.0	50.8	2	M12	76.0	2.64	FM / UL / LPCB / VDS
	2" / 50	88.9	60.3	95.0	160.0	105.0	63.5	2	M12	76.0	2.40	FM / UL / LPCB / VDS
4" / 100	1¼" / 32	114.3	42.4	104.0	187.0	96.0	50.8	2	M12	76.0	2.78	FM / UL / LPCB / VDS
	1½" / 40	114.3	48.3	104.0	187.0	96.0	50.8	2	M12	76.0	2.79	FM / UL / LPCB / VDS
	2" / 50	114.3	60.3	104.0	187.0	107.0	63.5	2	M12	76.0	3.22	FM / UL / LPCB / VDS
	2½" / 65	114.3	76.1	104.0	187.0	106.0	69.8	2	M12	76.0	3.57	FM / UL / VDS
	3" / 80	114.3	88.9	113.0	187.0	130.0	88.9	2	M12	76.0	5.60	FM / UL / VDS
5" / 125	1¼" / 32	139.7	42.4	119.0	216.0	100.0	50.8	2	M16	89.0	3.98	FM / VDS
	1½" / 40	139.7	48.3	119.0	216.0	100.0	50.8	2	M16	89.0	4.06	FM / VDS
	2" / 50	139.7	60.3	119.0	216.0	106.0	63.5	2	M16	89.0	4.30	FM / VDS
	2½" / 65	139.7	76.1	119.0	216.0	107.0	69.8	2	M16	89.0	4.60	FM / VDS
6" OD	1¼" / 32	165.1	42.4	128.5	245.0	96.0	50.8	2	M16	120.0	4.32	FM / LPCB / VDS
	1½" / 40	165.1	48.3	128.5	245.0	96.0	50.8	2	M16	120.0	4.31	FM / LPCB / VDS
	2" / 50	165.1	60.3	132.0	245.0	107.0	63.5	2	M16	120.0	4.81	FM / LPCB / VDS
	2½" / 65	165.1	76.1	129.0	245.0	107.0	69.8	2	M16	120.0	5.27	FM / LPCB / VDS
	3" / 80	165.1	88.9	135.5	245.0	140.0	88.9	2	M16	120.0	5.65	FM / UL / VDS
	4" / 100	165.1	114.3	137.0	245.0	156.0	114.3	2	M16	120.0	5.70	FM / UL / VDS
6" / 150	1¼" / 32	168.3	42.4	133.0	245.0	96.0	50.8	2	M16	120.0	4.23	FM / UL / LPCB / VDS
	1½" / 40	168.3	48.3	130.5	245.0	96.0	50.8	2	M16	120.0	4.33	FM / UL / LPCB / VDS
	2" / 50	168.3	60.3	131.5	245.0	107.0	63.5	2	M16	120.0	4.92	FM / UL / LPCB / VDS
	2½" / 65	168.3	76.1	132.5	245.0	107.0	69.8	2	M16	120.0	5.15	FM / UL / LPCB / VDS
	3" / 80	168.3	88.9	138.5	247.0	140.0	88.9	2	M16	120.0	7.21	FM / UL / VDS
	4" / 100	168.3	114.3	139.5	247.0	163.0	114.3	2	M16	120.0	6.24	FM / UL / LPCB / VDS
8" / 200	2½" / 65	219.1	76.1	155.0	320.0	120.0	69.8	2	M20	120.0	6.24	-
	3" / 80	219.1	88.9	161.0	320.0	138.0	88.9	2	M20	120.0	7.63	VDS
	4" / 100	219.1	114.3	161.0	320.0	164.0	114.3	2	M20	120.0	7.79	VDS